

F-10

REAR BRAKE PANEL

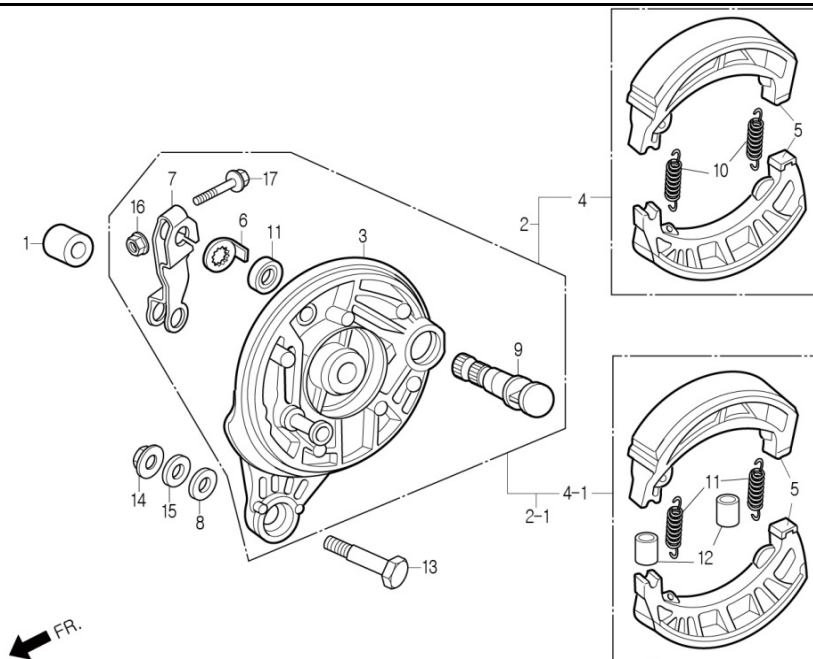

Service item	FRT	Ref No.	Part No.	Description	QTY	A/S	Exch	Start Date	End Date	Start FRM.No	End FRM.No
PANEL COMP., RR.BRAKE (INCLUDE RELATIVE PARTS)	0.5	1	42313-CB3-0000	COLLAR, RR.BRAKE PANEL SIDE	1	Y		20030320	20071231	KMYCB4BLS3C000001	KMYCB4BLS8C003290
		2	43000-CB4-RB00	PANEL ASS'Y, RR.BRAKE	1	N	Y	20030320	20060205	KMYCB4BLS3C000001	KMYCB4BLS6C002227
ARM, RR.BRAKE (INCLUDE RELATIVE PARTS)	0.1	2-1	43000-CB4-RB10	PANEL ASS'Y, RR.BRAKE	1	Y		20060206	20071231	KMYCB4BLS6C002228	KMYCB4BLS8C003290
		3	43100-CD1-0000	PANEL COMP., RR.BRAKE	1	N		20030320	20071231	KMYCB4BLS3C000001	KMYCB4BLS8C003290
SHOE COMP., BRAKE (ONE OR ALL)	0.4	4	4312A-SA1-0000-EU	SHOE ASS'Y, BRAKE	1	N	Y	20030320	20060205	KMYCB4BLS3C000001	KMYCB4BLS6C002227
		4-1	4312A-CB4-0000	SHOE ASS'Y, BRAKE	1	Y		20060206	20071231	KMYCB4BLS6C002228	KMYCB4BLS8C003290
		5	43120-SA1-0000-EU	SHOE COMP., BRAKE	2	N		20030320	20071231	KMYCB4BLS3C000001	KMYCB4BLS8C003290
		6	43145-CB3-0000	INDICATOR, RR.BRAKE	1	N		20030320	20071231	KMYCB4BLS3C000001	KMYCB4BLS8C003290
		7	43410-CB4-0000	ARM, RR.BRAKE	1	N		20030320	20071231	KMYCB4BLS3C000001	KMYCB4BLS8C003290
		8	43434-BA6-0000	RUBBER, STOPPER ARM CUSHION	1	Y		20030320	20071231	KMYCB4BLS3C000001	KMYCB4BLS8C003290
		9	45131-CB2-9400	CAM, FRONT BRAKE	1	N	Y	20030320	20030925	KMYCB4BLS3C000001	KMYCB4BLS4C000964
			45131-CB2-9400-M1	CAM, FRONT BRAKE	1	Y		20030926	20071231	KMYCB4BLS4C000965	KMYCB4BLS8C003290
		10	45133-CB2-0000	SPRING, RR.BRAKE SHOE	2	N		20030320	20071231	KMYCB4BLS3C000001	KMYCB4BLS8C003290
		11	45134-CB2-0000	SEAL, BRAKE CAM DUST	1	N		20030320	20071231	KMYCB4BLS3C000001	KMYCB4BLS8C003290
		12	46519-CB4-0000	TUBE, SPRING	2	N		20060206	20071231	KMYCB4BLS6C002228	KMYCB4BLS8C003290
		13	90127-CB3-0000	BOLT, RR.BRAKE STOPPER	1	Y		20030320	20071231	KMYCB4BLS3C000001	KMYCB4BLS8C003290
		14	90309-CB3-0000	NUT, FLANGE, 8mm	1	Y		20030320	20071231	KMYCB4BLS3C000001	KMYCB4BLS8C003290
		15	90505-BA6-0000	WASHER, 8mm	1	Y		20030320	20071231	KMYCB4BLS3C000001	KMYCB4BLS8C003290
		16	S4050-06080	NUT, FLANGE, 6mm	1	N		20030320	20071231	KMYCB4BLS3C000001	KMYCB4BLS8C003290
		17	S5701-06032-08	BOLT, FLANGE, 6x32	1	N		20030320	20071231	KMYCB4BLS3C000001	KMYCB4BLS8C003290