

**F-25**

**WINKER**

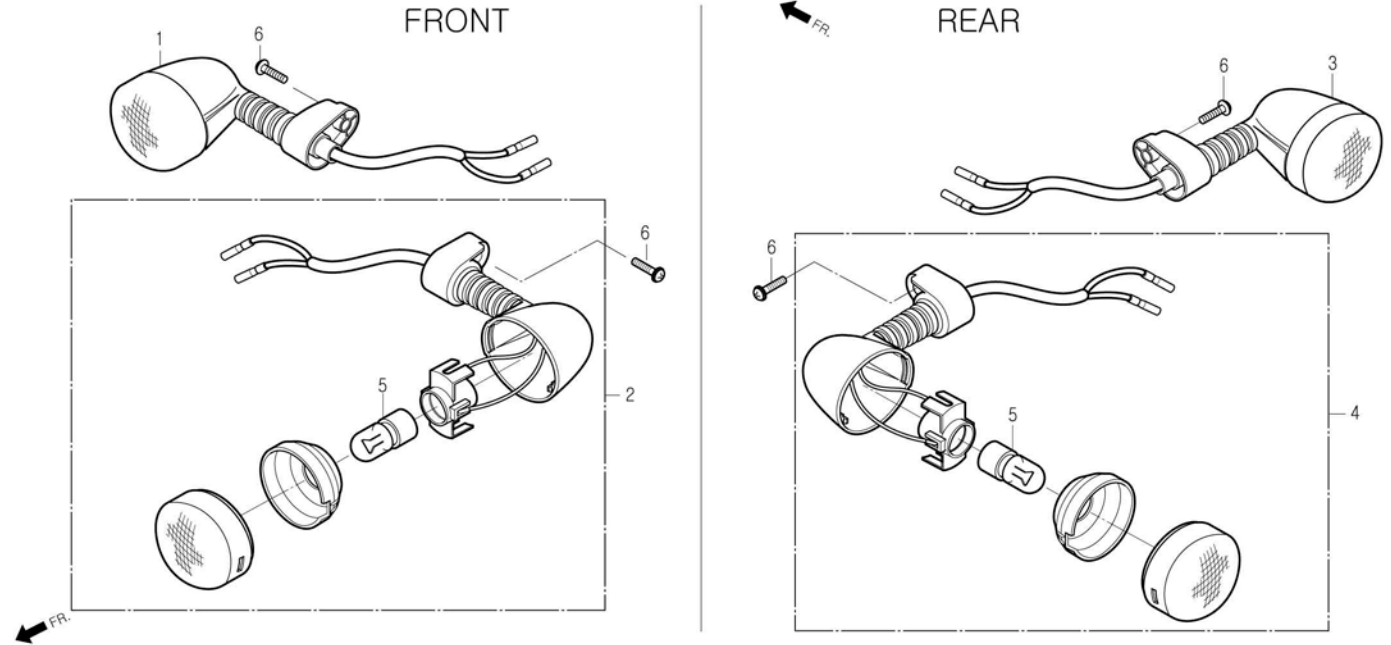

Service item	FRT	Ref No.	Part No.	Description	QTY	A/S	Exch	Start Date	End Date	Start FRM.No	End FRM.No
WINKER ASS'Y (ADD 0.1 FOR EACH) (INCLUDE RELATIVE PARTS)	0.2	1	33400-CB4-RH00	WINKER ASS'Y, RH.FR.	1	N	Y	20030320	20040419	KMYCB4BLS3C000001	KMYCB4BLS4C001446
			33400-CB4-RH10	WINKER ASS'Y, RH.FR.	1	Y		20040420		KMYCB4BLS4C001447	
			33450-CB4-RH00	WINKER ASS'Y, LH.FR.	1	N	Y	20030320	20040419	KMYCB4BLS3C000001	KMYCB4BLS4C001446
			33450-CB4-RH10	WINKER ASS'Y, LH.FR.	1	Y		20040420		KMYCB4BLS4C001447	
BULB, WINKER	0.1	3	33600-CB4-RH00	WINKER ASS'Y, RH.RR.	1	N	Y	20030320	20040419	KMYCB4BLS3C000001	KMYCB4BLS4C001446
			33600-CB4-RH10	WINKER ASS'Y, RH.RR.	1	Y		20040420		KMYCB4BLS4C001447	
			33650-CB4-RH00	WINKER ASS'Y, LH.RR.	1	N	Y	20030320	20040419	KMYCB4BLS3C000001	KMYCB4BLS4C001446
			33650-CB4-RH10	WINKER ASS'Y, LH.RR.	1	Y		20040420		KMYCB4BLS4C001447	
			34905-BA7-RB00	BULB, WINKER(12V 10W)	4	Y		20030320		KMYCB4BLS3C000001	
		6	S3500-05016-0H	SCREW, PAN, 5x16	4	N	Y	20030320	20100430	KMYCB4BLS3C000001	KMYCB4BLSAC003718
			S3500-05016-0A	SCREW, PAN, 5x16	4	Y		20100501		KMYCB4BLSAC003719	