

E-04

CAM CHAIN / TENSIONER

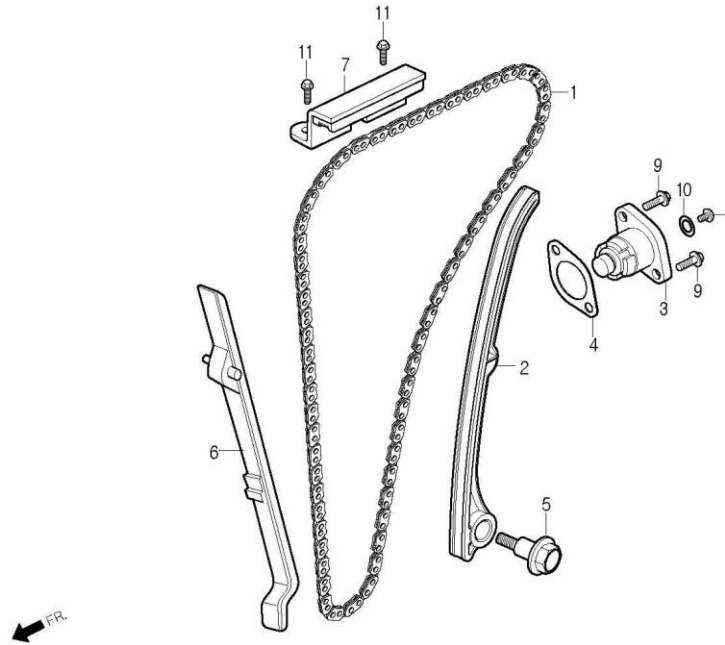

Service item	FRT	Ref No.	Part No.	Description	QTY	A/S	Exch	Start Date	End Date	Start FRM.No	End FRM.No
CHAIN, CAM	*1.6	1	14401-BA8-0000	CHAIN, CAM	1	N	Y	20070425	20140331	KMYBA8BLS7C000001	KMYBA8BLSEC004885
			14401-BA8-0000-M1	CHAIN, CAM(122L)	1	Y		20140401		KMYBA8BLSEC004886	
ARM COMP., CAM CHAIN TENSIONER	*0.6	2	14500-BA8-0000	ARM COMP., CAM CHAIN TENSIONER	1	N	Y	20070425	20140622	KMYBA8BLS7C000001	KMYBA8BLSFC005047
			14500-SAB-0000	ARM COMP., CAM CHAIN TENSIONER	1	Y		20140623		KMYBA8BLSFC005048	
LIFTER ASS'Y, TENSIONER	0.4	3	14520-BA1-0000	LIFTER ASS'Y, TENSIONER	1	N	Y	20070425	20140721	KMYBA8BLS7C000001	KMYBA8BLSFC005087
			14520-SAB-0000	LIFTER ASS'Y, TENSIONER	1	N	Y	20140722	20150922	KMYBA8BLSFC005088	KMYBA8BLSGC005500
GUIDE, CAM CHAIN	2.2		14520-SAB-0010	LIFTER ASS'Y, TENSIONER	1	Y		20150923		KMYBA8BLSGC005501	
		4	14523-BA7-0000-EU	GASKET, TENSIONER LIFTER	1	Y		20070425		KMYBA8BLS7C000001	
		5	14531-BA8-0000	PIVOT, CAM CHAIN TENSIONER	1	Y		20070425		KMYBA8BLS7C000001	
		6	14550-BA8-0000	GUIDE, CAM CHAIN	1	N	Y	20070425	20140622	KMYBA8BLS7C000001	KMYBA8BLSFC005047
			14550-SAB-0000	GUIDE,CAM CHAIN	1	Y		20140623		KMYBA8BLSFC005048	
		7	14560-BA8-0000	GUIDE B, CAM CHAIN	1	Y		20070425		KMYBA8BLS7C000001	
		8	90005-BA7-9000	SCREW, PAN, 6x6	1	Y		20070425		KMYBA8BLS7C000001	
		9	90091-BA7-0000	BOLT, FLANGE, 6x16	2	N	Y	20070425	20150305	KMYBA8BLS7C000001	KMYBA8BLSFC005379
			S6001-06016-00	BOLT, FLANGE, SH.6x16	2	Y		20150306		KMYBA8BLSFC005380	
		10	91306-BA6-6900	O-RING, 9.5x1.5	1	Y		20070425		KMYBA8BLS7C000001	
		11	S5701-06016-00	BOLT, FLANGE, 6x16	2	Y		20070425		KMYBA8BLS7C000001	